

Presents

Sri Krishna Awadh Enclave

At - Hehal, Ratu Road, Ranchi



SRI KRISHNA CITY HOMES PVT. LTD.

501, Mangal Tower, Near Katatoli More, Ranchi

Phone : 07781048405, 0651-2532834

E-mail : ksp_ibarkhand@gmail.com

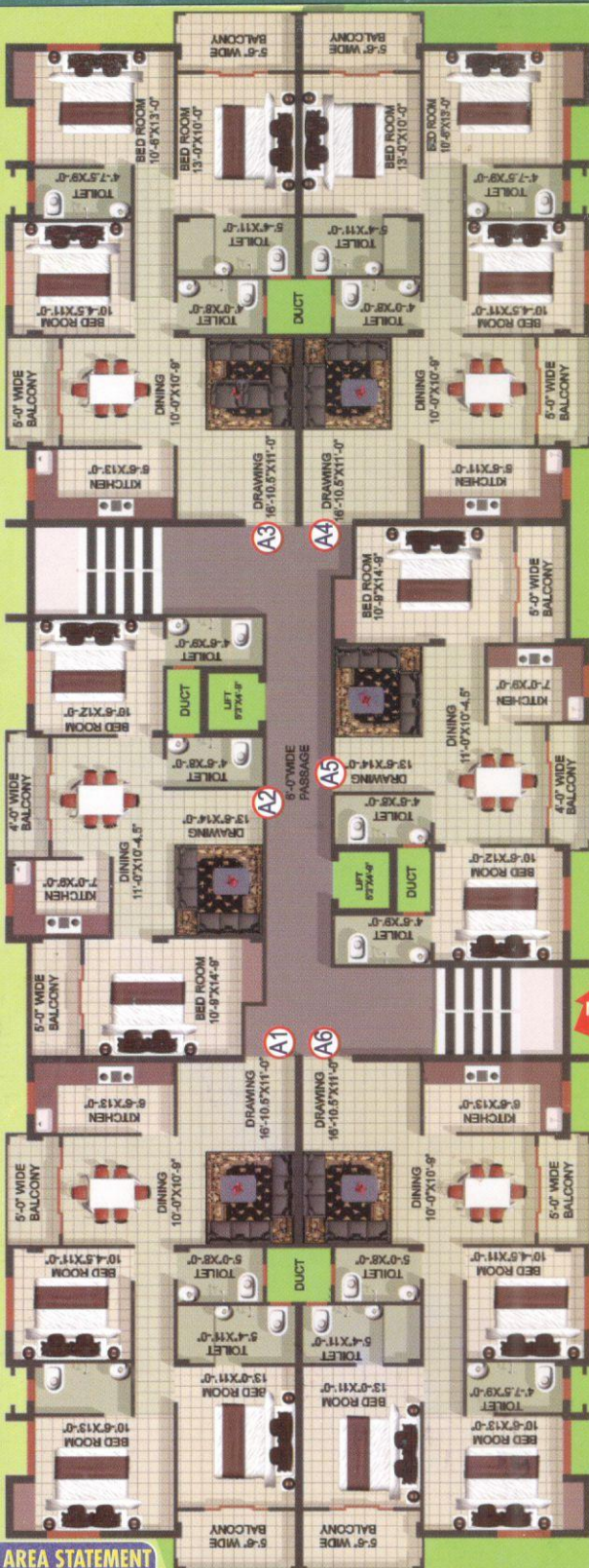

AREA STATEMENT

F.NO	A1	A2	A3	A4	A5	A6
AREA	1480sqft	1110sqft	1480sqft	1480sqft	1110sqft	1480sqft



SPECIFICATION OF FLATS

FOUNDATION

: Split R.C.C. foundation

STRUCTURE

: R.C.C. framed structure

SUPER STRUCTURE

: Construction will be of brickwork, 9" thick red Bricks/flyash brick work in main wall and all internal brick work 4.5" thick.

PLASTERING

: 1:6 Cement mortar plastering inside & Outside.

WALL FINISH

: (a) Internal wall finish: approved quality plaster of Paris (b) External wall finish 1:6 Cement mortar plaster finished with exterior paint.

FLOORING

: Vitrified tiles and stair steps will be finished with marble/kota stone.

GARRAGE FLOORING

: Garage floor will be finished with I.P.S. & neat cement punning;

BATHROOM/TOILETS

: (a) Floor : Mat finish ceramic tiles. (b) Walls : Printed glazed tiles upto 7'-0" (c) Sanitary ware : Vitreous white ceramic set make with PVC cistern. (d) Fittings : In attached toilet one European W.C. With PVC L/D cistern & one wash basin (White). One shower, one soap tray in general toilet one I.C. with PVC/L/D cistern and one wash basin, one towel rail, one shower, one water line : Hot and cold water line will be provided in attached toilet only (no geyser) (f) One Wash basin, one mirror & provided in dining area at suitable place. (g) All C.P. fittings will be of standard make.

KITCHEN

: Cooking platform - black granite & printed glazed tiles in walls upto 3'-0" over cooking platform area. One Stainless steel sink & one C. P. bib Cock.

DOORS

: 32mm thick Flush door finished with one coat of wood primer and 2 coats of synthetic enamel paint.

DOOR FRAME

: Wooden door frame.

WINDOWS

: Aluminums with plane glass 4 mm thick.

ELECTRICAL

: All rooms with concealed wiring with copper conductor of standard make. All rooms to have two light points, one fan point in living and dining space, two fan points, four light points, two nos. of 5 amp. plug point and one refrigerator and one T.V. will be provided at suitable place. In kitchen one 15 amp. & 1 No. 5 amps. plug point, 1 light point & one exhaust fan point will be provided. In toilet, one exhaust fan, one light and one geyser (A.T.) point will be provided outside the main door.

Note : The Consumer (Buyer) have to pay the cost of meter and any security deposit to the concern authority through our company.

SEWERAGES

: I.S.I. marked PVC pipe for sewer line work.

ELECTRICITY

: Electricity will be provided through J.S.E.B.

EMERGENCY

: One silent generator set of standard make having suitable capacity;

WATER SUPPLY

: Round the clock water supply ensured with overhead tank from suitable sources.



RULE OF NT

of
greement :

ek from the date of
00%(including
ount)of total
ion amount

onths from the date
ent or foundation :
al consideration

onths from the date
ent or 1st roof slab :
al consideration

onths from the date of agreement or 2nd roof slab : 10% of total
ion amount

onths from the date of agreement or 3rd roof slab : 10% of total
ion amount

onths from the date of agreement or 4th roof slab : 10% of total
ion amount

onths from the date of agreement or 5th roof slab : 10% of total
ion amount

onths from the date of agreement or brick work : 5% of total
ion amount

onths from the date of agreement or flooring : 5 % of total
ion amount

onths from the date of agreement or finishing : 5% of total
ion amount

of handover : 5% of total consideration amount

tax and any kind of tax according to govt rule will be paid by the party



AREA STATEMENT

F.NO	AREA
B1	1589sqft
B2	0951sqft
B3	1450sqft
B4	1480sqft
B5	1110sqft



LOCATION MAP



AVITOSH KUMAR P
Architect
 E/488 , A-Block, Sonari
 Phone : 09835131530,
 E.mail :- avitosh007@g